

Fitting Quick Installation Guide

Installing a Preformed Insert and Fitting Cover

Step 1:

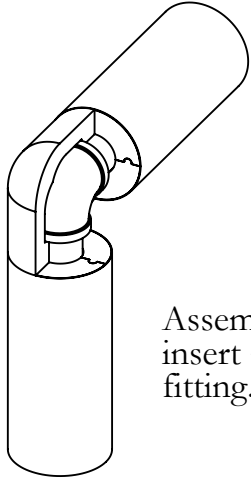

Assemble the preformed insert around the pipe fitting.

Step 2:

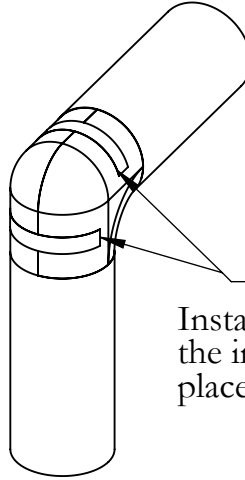

Spot tape in place
Install the second half of the insert and spot tape in place.

Step 3:

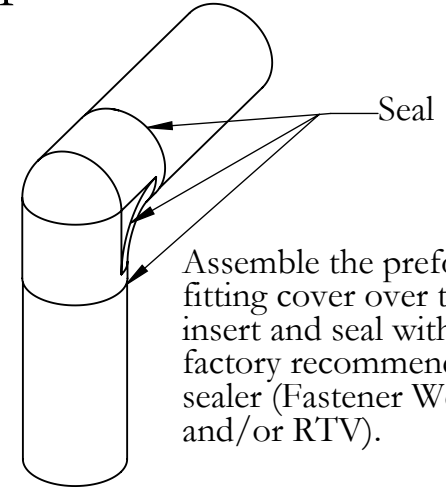

Seal
Assemble the preformed fitting cover over the insert and seal with a factory recommended sealer (Fastener Weld and/or RTV).

Installing a Diaper Insert and Fitting Cover

Step 1:

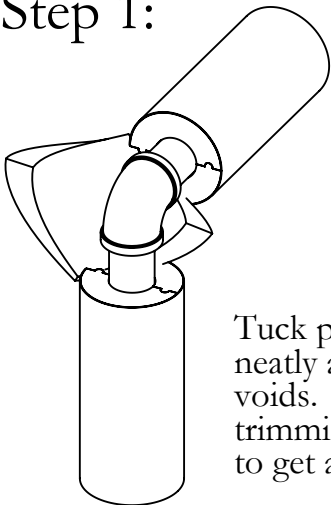

Tuck pre-cut diaper insert neatly and be sure to fill all voids. Some additional trimming may be required to get a good fit.

Step 2:

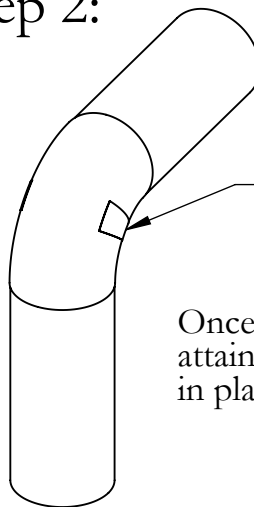

Spot Tape in place
Once the desired fit is attained, spot tape to hold in place.

Step 3:

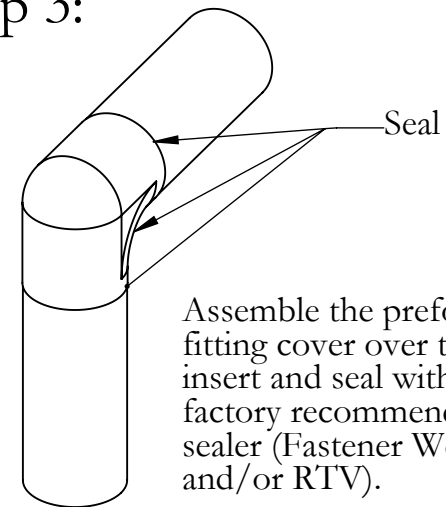

Seal
Assemble the preformed fitting cover over the insert and seal with a factory recommended sealer (Fastener Weld and/or RTV).